

Geography: Confusing Maps

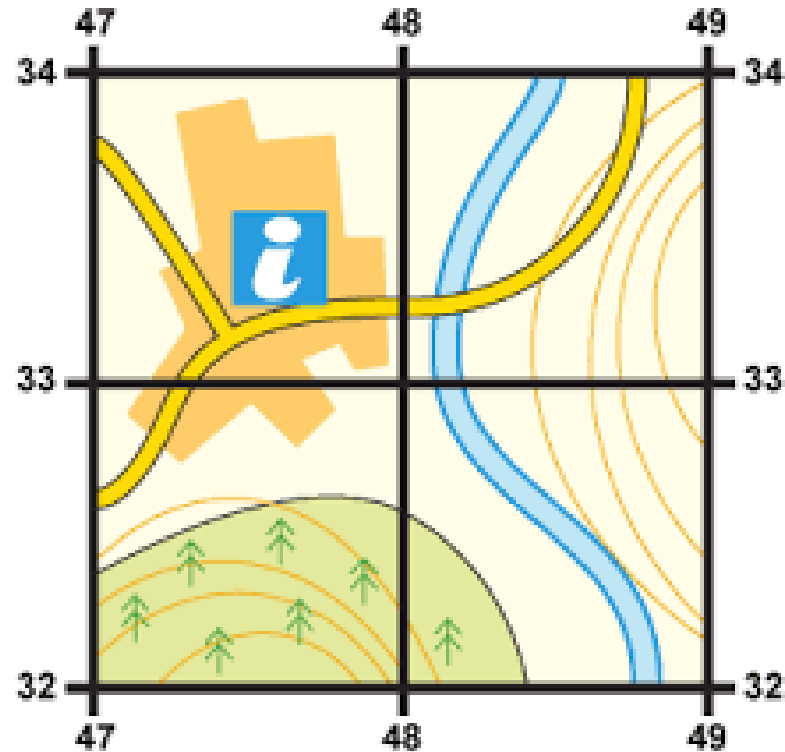

What are Map Skills?

The ability to
read and
understand
maps.

Extremely
useful if
technology
fails.

To see
dangers,
warnings and
potential
problems.

GO ALONG THE CORRIDOR BEFORE GOING UP THE STAIRS!

Y-axis

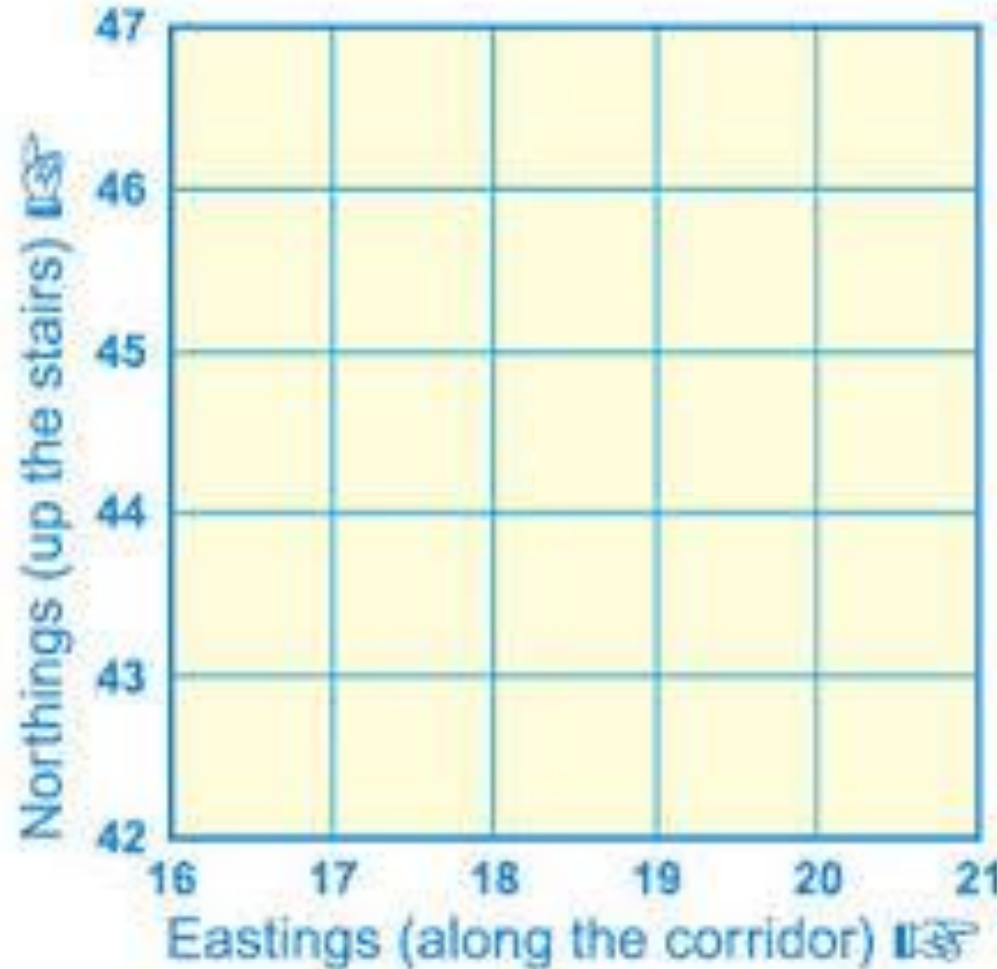
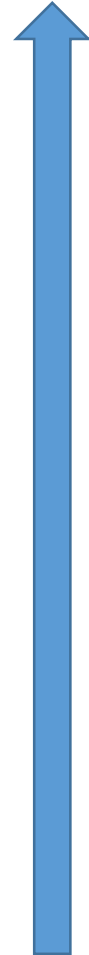

X-axis

When we find any kind of map reference or coordinate, we need to find the number on the **x-axis** first and then the number on the **y-axis**.

Activity 1

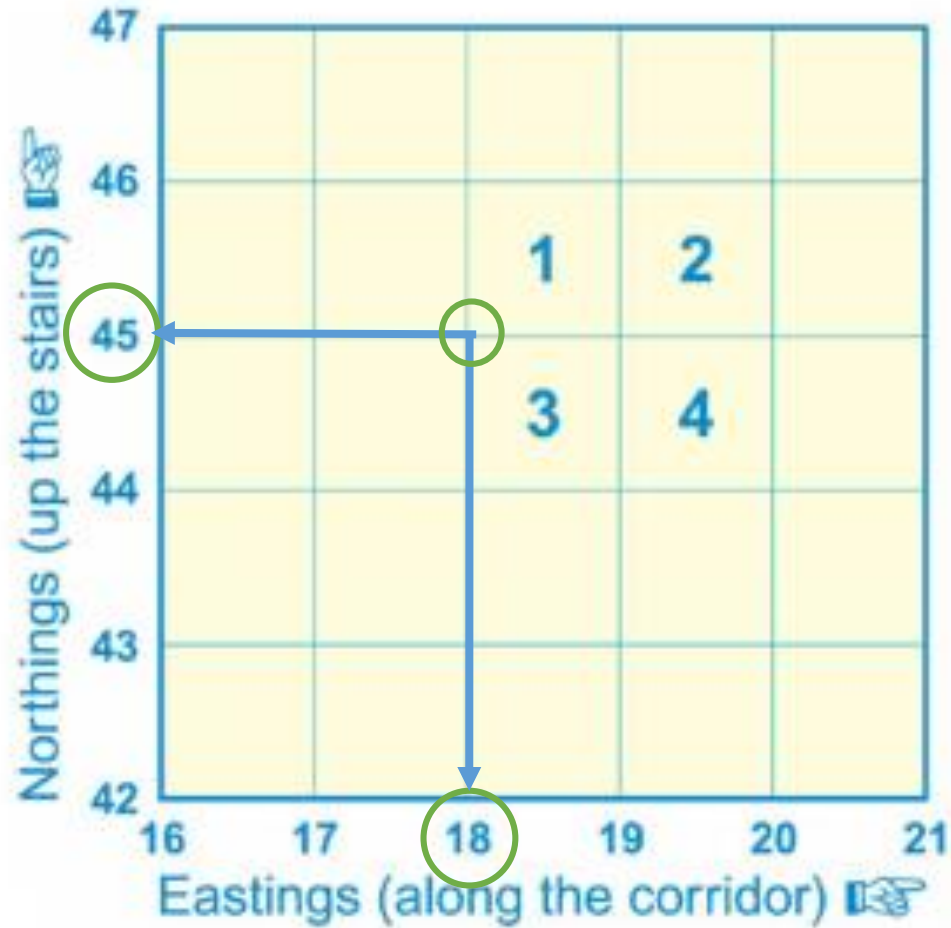

Take a look!

The co – ordinates of **1** are (18,45).

In your Home Learning Books, write the co-ordinates for 2, 3 & 4.

Symbol Key

On a map
you'll be
given a 'key'.

OS Map Symbols						
 Railway Station	 Local Driveway	 Railway	 Track or main road	 Footpath	 Airfield	 National Trail/Long Distance Route/Recreational Route
 Cemeteries (various sites)	 Wessex	 Place site	 Energy infrastructure point	 Building of historic interest	 Preservation/conservation site	 Museum
 Site of battle	 Castle/fort	 Other World Heritage Monument	 Historic building	 English Heritage	 National Park boundary	 Nature reserve
 Access land in mountain area	 Access land boundary and end	 Cycle route	 Information centre	 Telephone	 Parking	 Barbed wire/fence
 Place of worship with spire, tower or steeple	 Place of worship with tower	 Place of worship	 Public house	 School	 Post office	 Public convenience
 Bus or coach station	 COP	 Wind pump, wind generator	 Electricity transmission line	 Quarry	 Footbridge	 Well, spring
 Non-wooded trees	 Wooded trees	 Marsh, reeds or tall grass	 Ditch	 Bracken, heath or rough ground	 Bank	 Culvert
 Scrub		 Bank, sand & shingle	 Mud			

A key works like a glossary in a book. It tells you what all the symbols on a map mean.

Can you guess the symbol?

Match the symbol to description on the sheet or in your Home Learning Book.



Campsite

School

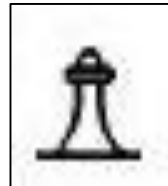

Place of Worship
(with a tower)

Lighthouse

Sch



Museum

Lighthouse (Disused)